



EMR Lockset Installation Instructions

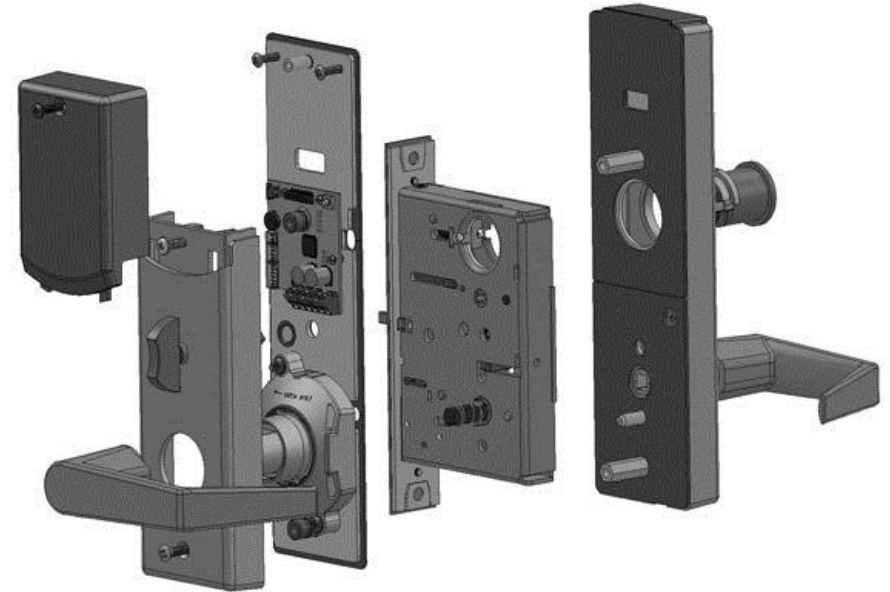

Table of Contents

Lock Body Installation.....	1
Inside Trim Installation.....	2
Outside Trim Installation.....	4
Key/Cylinder Installation	6
Armor Plate and Battery Installation	7
Hard Wired Lock Body Installation.....	8
Wiring Guide.....	8
Rehanding	9

TellCard Systems
P. O. Box 485
Leola, PA 17540
855-200-2611

P/N 88306 Rev 0 12/31/12



Lock Body Installation

LH/LHR Installation Shown

1. Check lock handing. See diagram for correct handing. If handing is not correct, see **Rehanding** on page 9.

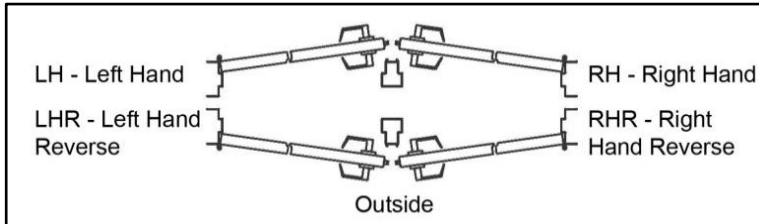

2. As needed, prepare door, using supplied template (P/N 88305).
3. **Battery-Powered (No External Wire Connection):** Install lock body and route motor wire (1).

Hard-Wired (External Wire Connection): Install lock body, route motor wire (1), and pull terminal wires (2) from hinge side of door through hole.

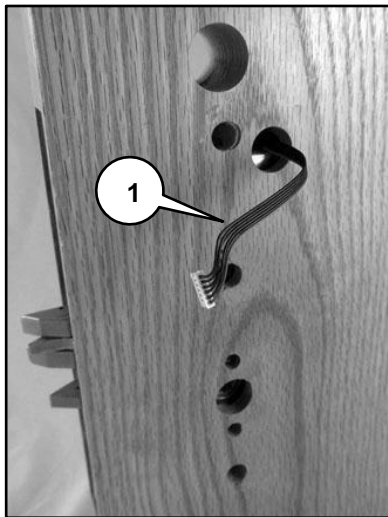

Battery Powered

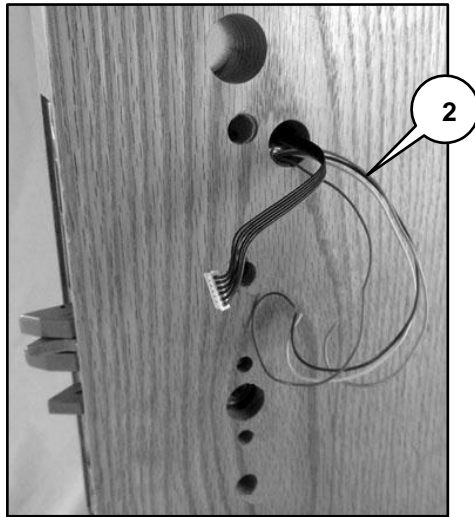

Hard Wired

Rehanding (Cont'd)

Inside Trim

1. Remove rose plate (21) by removing two screws (21a).
2. Rotate rose plate 180° from original orientation. Arrows on rose plate point toward latch. Make sure spindle adapter is installed.
3. Reinstall rose plate with two screws.

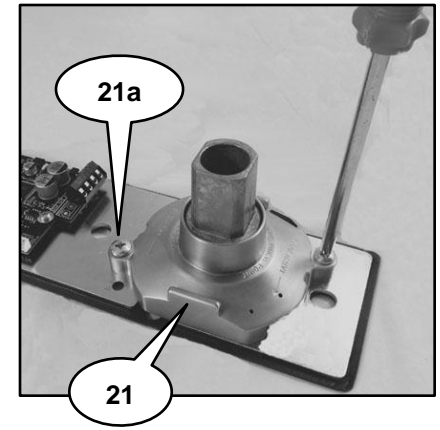

Rehanding

Outside Trim (Do Not Remove Outside Lever)

1. Remove lower back plate (18) by removing two screws (18a). Remove lower through bolt (19).

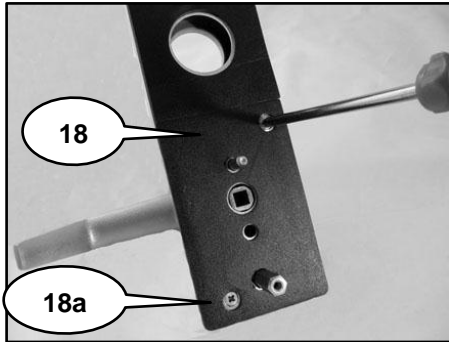

2. Rotate lever/rose assembly 180° from original orientation. Reinstall rose plate with two screws. Make sure spindle adapter (20) is installed.

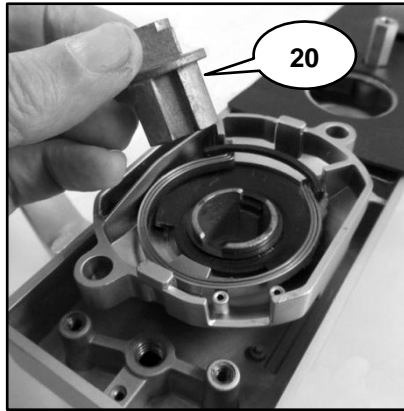
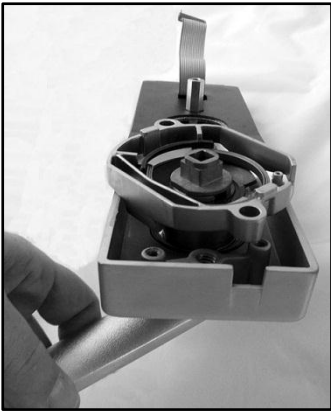

3. Reinstall lower through bolt, then lower black plate with two screws.

Inside Trim Installation

4. Get inside trim. Remove battery cover (3) by removing #8-32 x 5/8" panhead screw (3a) and rotating cover outward from top. Set cover and screw aside.

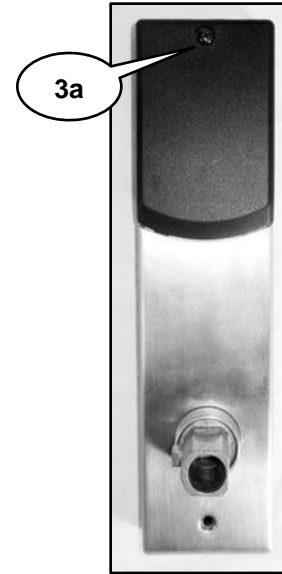

Inside Trim

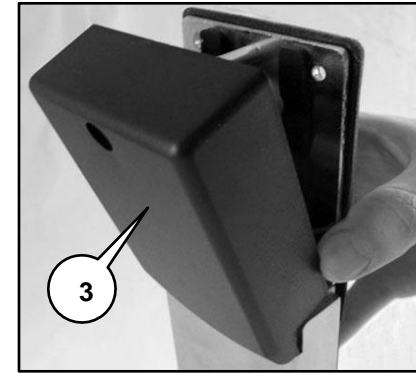

5. Remove shipping screw (4) from back plate (5). Discard. Separate escutcheon (6) from back plate.

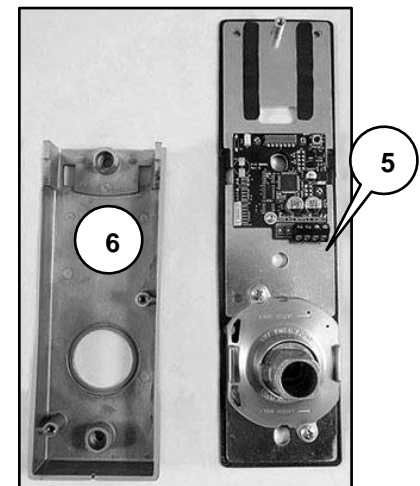
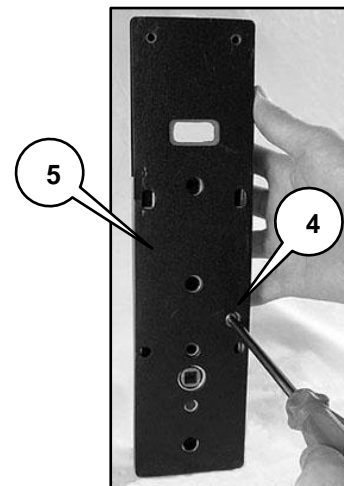

Inside Trim Installation (Cont'd)

6. Install spring and spindle (7) on inside face of door. See Spindle Orientation.

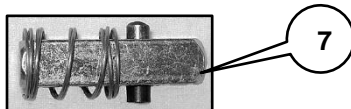

Spindle Orientation

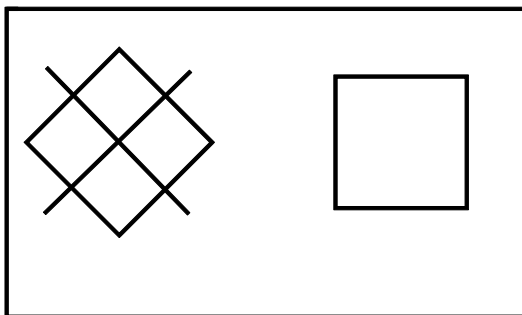

7. Install back plate. Secure with two #8-3/4" surface mount screws (8) (Battery-powered installation shown).

Route motor wire (1) to side of circuit board. Connect wire to white terminal (9) on circuit board.

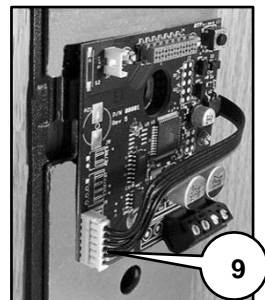
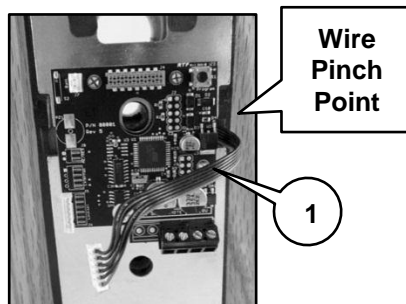
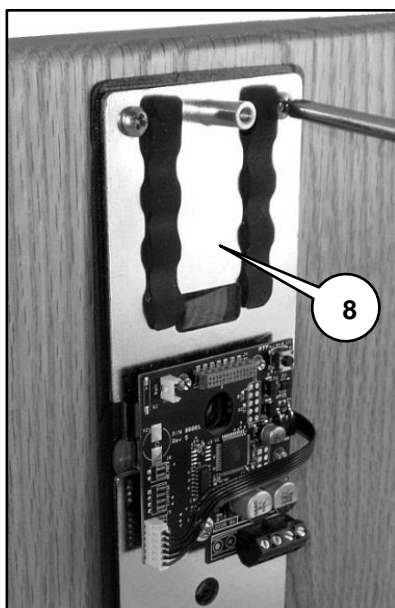

Hard Wired (External Wire Connection) Installation

19. Terminate wires into black terminal(s) (17). See Terminal Connections. Return to Step 9 on page 4.

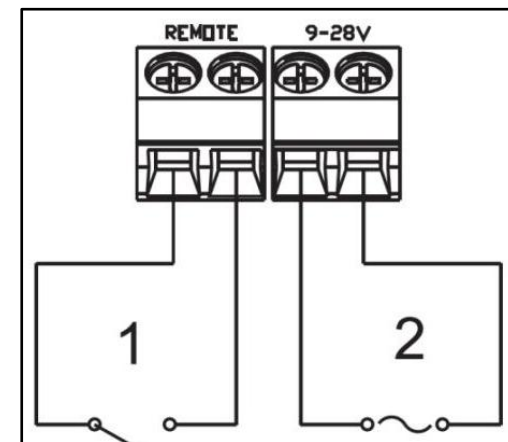
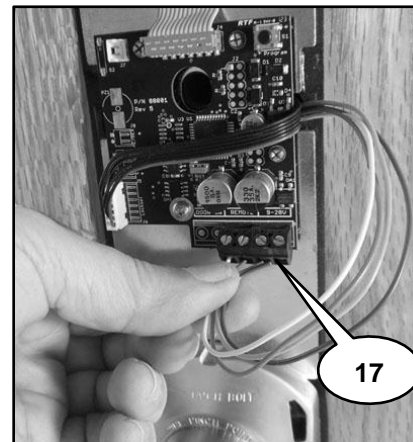

1. Remote Release Switch – SPST – N.O.
2. External Power – 12V to 24V AC or DC. Polarity not important.

Wiring Guide

Power may be supplied one of three ways:

20. Four AA alkaline batteries
21. Hard wired to 12V to 24V DC Power Supply
22. Hard wired to 12V to 24V AC Power Supply

External Power Requirements

- Voltage: 12 to 24VDC or 12 to 24VAC
- Current: Max current 0.30A

Outside Trim Installation (Cont'd)

12. Install inside escutcheon (12) to back plate with two #10-24 x 2" screws (12a).

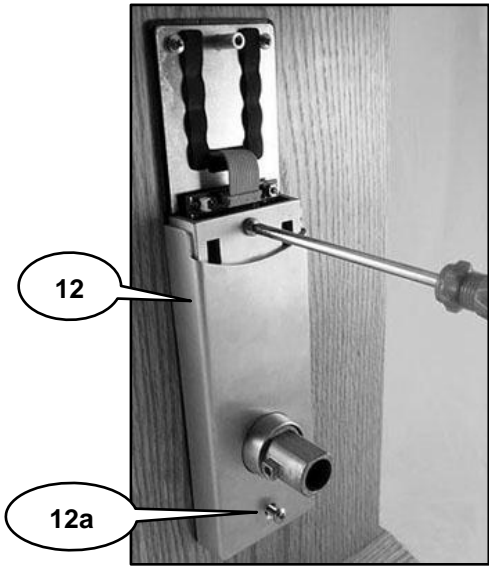

13. Install lever (13) to inside escutcheon with M5 x 0.8 mm x 8 mm extended point screw (13a), using provided 2.5 mm Allen wrench (hex key).

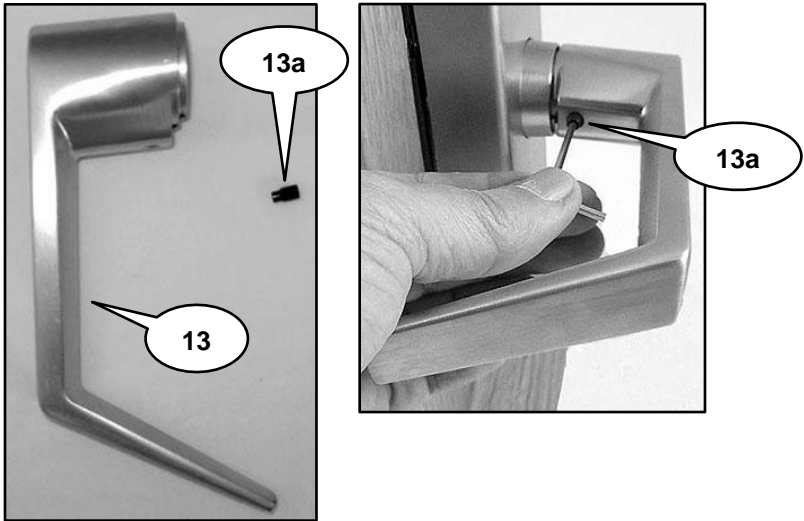

Key/Cylinder Installation

14. If PDQ-provided key/cylinder, install key/cylinder (14).

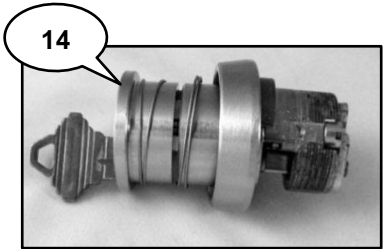

If customer-provided key/cylinder, install PDQ-provided parts to the key/cylinder in the following order: spring (14a), trim collar (14b), and rim cylinder adapter (14c) to key/cylinder. Install parts with two screws (14d).

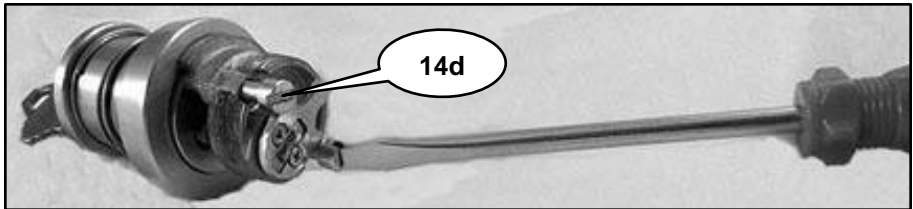
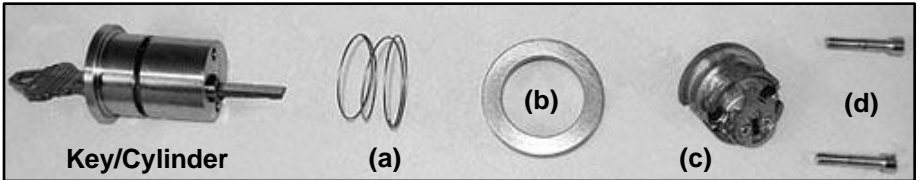

15. Thread cylinder (14) into door until parts are flush with each other.

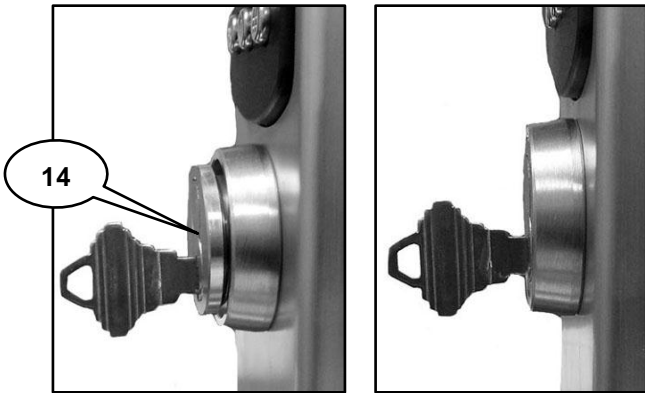

Armor Plate and Battery Installation

16. Insert 2.5 mm Allen wrench (hex key) into set screw inside of lock body, closest to cylinder. Turn wrench until cylinder locks.

17. Install armor plate (15) with two #8-32 x 1/4" flathead screws (15a).

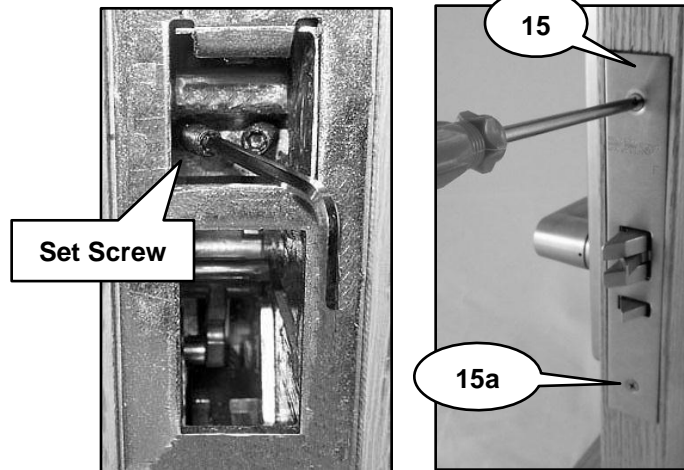

18. Install four AA batteries into battery cover (3). Connect battery pack to white terminal (16) on circuit board. Install battery pack/cover. Secure cover with screw.

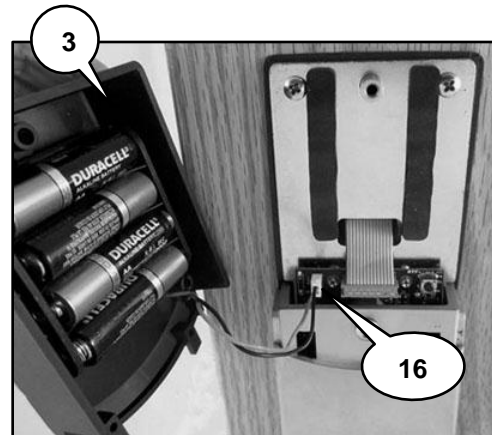

Outside Trim Installation

8. If battery-powered, go to next step (Step 9). If hard wired, go to Step 19 on pg. 8.

9. Install second spring and spindle. See **Spindle Orientation** and **Step 6** for photos.

10. Install outside trim. Pull main wire harness (10) through door.



Outside Trim

11. Gently pull excess wire through inside back plate while installing outside trim. Plug wire into red terminal (11) on circuit board.

